



Bradford Street | Walsall | WS1 3QA

£650 PCM

 **Webbs**
estate agents

Summary

Webbs Estate Agents are delighted to offer to let this ground floor flat, situated in the heart of Walsall town centre, just a stones throw from local amenities. With excellent public transport links and within easy access of major road networks.

In brief, the accommodation comprises of; spacious lounge, breakfast kitchen, double bedroom & shower room.

Parking available upon request - Please call for details.

Key Features

Rooms and Dimensions

PROPERTY DETAILS:

Kitchen

6'1" x 8'7" (1.86 x 2.63)

Lounge

16'11" x 12'3" (5.16 x 3.75)

Bedroom

13'0" x 7'10" (3.97 x 2.39)

Bathroom

4'10" x 5'6" (1.48 x 1.69)

TENANCY INFORMATION & IMPORTANT NOTES





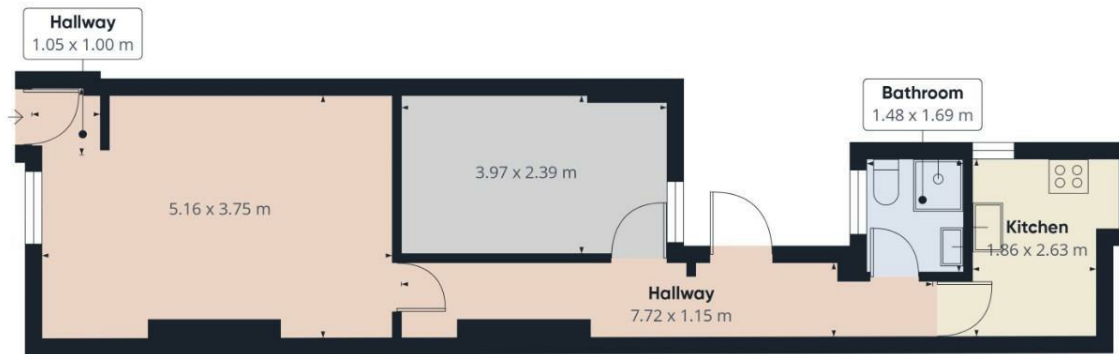

Approximate total area⁽¹⁾
45.1 m²

(1) Excluding balconies and terraces

While every attempt has been made to ensure accuracy, all measurements are approximate, not to scale. This floor plan is for illustrative purposes only.

Calculations are based on RICS IPMS 3C standard.

GIRAFFE360

Webbs Estate Agents - endeavour to maintain accurate depictions of properties in Virtual Tours, Floor Plans and descriptions, however, these are intended only as a guide and purchasers must satisfy themselves by personal inspection.

